

## The professional façade repair for two-leaf cavity walls



Repairing outer leaves



Detail: Repairing outer leaves

### VERSIONS

- Stainless steel

### BUILDING MATERIALS

- Facing masonry with and without an air layer

### CERTIFICATES



### ADVANTAGES

- The expansion-force-free fixing prevents splitting and cracks. This means that VBS 8 can be used even in old and sensitive masonry.
- The drill bit diameter of just 8 mm means that a minimal amount of mortar is required for each fixing point. Thus VBS 8 is particularly economical.
- The installation is approved anywhere along the entire bed joint, thus ensuring a high level of installation safety.
- The grey colour of the injection mortar is similar to the colour of the bed joint. This means that the fixing is almost invisible to the eye.

### APPLICATIONS

- Post-installation needling of two-skin cavity walls

### FUNCTIONING

- The remedial wall tie VBS 8 comprises a perforated plastic sleeve and a profiled A4 stainless steel tie Ø 4 mm.
- VBS 8 is used together with the injection mortar FIS V.
- The anchor is inserted in the bed joint of the outer leaf using push-through installation.

## INSTALLATION IN FACING MASONRY WITH FIS V AND VBS 8

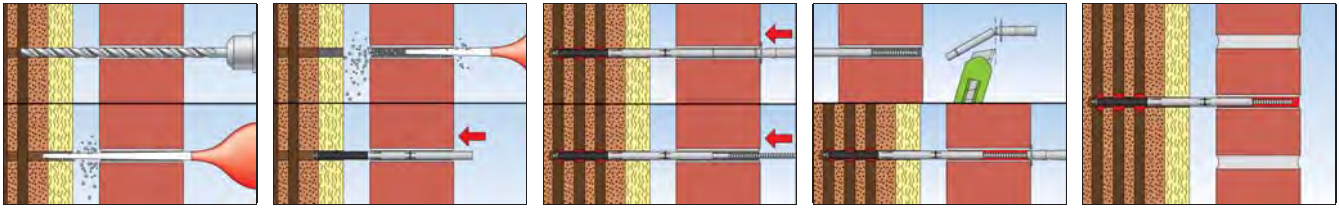

## TECHNICAL DATA



Remedial wall tie **VBS 8**

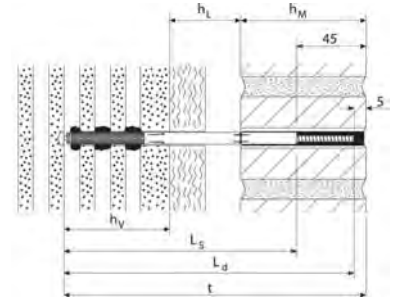

| Item             | Stainless steel    | Approval | Cavity or insulation | Drill hole diameter | Outer leaf | Depth = embedment depth | Fixing length | Anchorage depth | Fill quantity FIS V bearing wall | Sales unit |
|------------------|--------------------|----------|----------------------|---------------------|------------|-------------------------|---------------|-----------------|----------------------------------|------------|
|                  | Art.-No.           |          |                      |                     |            |                         |               |                 |                                  |            |
|                  | <b>A4</b>          |          |                      |                     |            |                         |               |                 |                                  |            |
| <b>VBS 8/20</b>  | <b>078763</b> 1)2) | ●        | 0 - 20               | 8                   | ≥ 90       | 195                     | 188           | >60             | 4                                | 100        |
| <b>VBS 8/50</b>  | <b>078799</b> 1)2) | ●        | 20 - 50              | 8                   | ≥ 90       | 225                     | 218           | >60             | 4                                | 100        |
| <b>VBS 8/80</b>  | <b>078800</b> 1)2) | ●        | 50 - 80              | 8                   | ≥ 90       | 255                     | 248           | >60             | 4                                | 100        |
| <b>VBS 8/120</b> | <b>078801</b> 1)2) | ●        | 80 - 120             | 8                   | ≥ 90       | 295                     | 288           | >60             | 6                                | 100        |
| <b>VBS 8/150</b> | <b>078802</b> 1)2) | ●        | 120 - 150            | 8                   | ≥ 90       | 325                     | 318           | >60             | 6                                | 100        |

1) Product consisting of perforated plastic sleeve, profiled wire A4 and injection nozzle.

2) For the closing of the curtain walling about 2-3 additional scale units of mortar FISV are required.

## ACCESSORIES



Compressed-air cleaning tool      Hammer drill SDS-Plus Pointer, DIN 8039

| Item                                 | Art.-No.      | Technical details  | Sales unit |
|--------------------------------------|---------------|--|------------|
|                                      |               |  | [pcs]      |
| <b>VBS 8 cleaning set</b>            | <b>090241</b> | content: cleaning brush and extension tube for blow-out pump               | 1          |
| <b>Compressed-air cleaning tool</b>  | <b>093286</b> | for professional cleaning of the drill hole                                | 1          |
| <b>SDS-Plus Pointer 8,0 / 460 mm</b> | <b>074330</b> | Hammer drill with self-centring drill bit and relief-ground drill grooving | 1          |